

EXTERIOR EQUIPMENT LIST

- 1 - 3'-0"X7'-0" HOLLOW CORE STEEL ENTRY DOOR
- 2 - MOTORIZED ARMLESS AWNING
- 3 - SLIDEROOM TOPPER AWNING (2)
- 4 - 5'-0"X2'-6" THERMOPLANE SLIDING WINDOW (2)
- 5 - 300 WATT HALOGEN EXTERIOR LIGHTS IN ENCLOSURE (6)
- 6 - 3 TON CENTRAL HVAC W/15KW HEAT STRIP
- 7 - EXTERIOR RECEPTACLE (6)
- 8 - 14' HYDRAULICALLY ACTUATED SLIDEROOM (2)
- 9 - TRAILER LANDING GEAR/STABILIZER JACK
- 10 - STORAGE COMPARTMENT (6)
- 11 - GENERATOR RADIATOR & BATTERY COMPARTMENT
- 12 - 20 KW DIESEL GENERATOR IN ENCLOSURE
- 13 - FOLD DOWN STEEL PLATFORM/RAMP
- 14 - COATED STEEL SKIRTING
- 15 - REAR STORAGE AREA FOR MONITOR

INTERIOR EQUIPMENT LIST

- 1 - 32" LCD MONITOR
- 2 - 30"X30"X12" WALL CABINET
- 3 - 4 CUBIC FOOT REFRIGERATOR
- 4 - FOLD DOWN STEEL PLATFORM & RAMP
- 5 - 36" TWO DRAWER FILE CABINET (5) WITH LAMINATE TOP
- 6 - 30"X30"X12" WALL CABINET (5)
- 7 - 5# FIRE EXTINGUISHER
- 8 - 3'-0"X7'-0" HOLLOW CORE STEEL ENTRY DOOR
- 9 - 36" MELAMINE FACED BASE CABINET WITH LAMINATE COUNTER TOP
- 10 - FABRIC UPHOLSTERED SETTEE
- 11 - 20" LCD MONITOR
- 12 - ADJUSTABLE DESK CHAIR (16)
- 13 - 30"X120" LAMINATE CONFERENCE TABLE
- 14 - 3 TON CENTRAL HVAC WITH 15KW HEAT STRIP
- 15 - 19"X84"X24" DEEP ELECTRONICS RACK
- 16 - 30" HIGH LAMINATE COUNTER TOP
- 17 - 30"X18"X24" TWO DRAWER FILE CABINET

INTERIOR FINISHES

- 1 - MEDIUM GRAY URETHANE LINER ON FLOOR, WALLS, & CEILING
- 2 - GRAY MATRIX HIGH PRESSURE LAMINATE
- 3 - BLACK LEATHER
- 4 - CHARCOAL FABRIC

ITEMS NOT SHOWN

INTERIOR FLUORESCENT LIGHTING THROUGHOUT
 SMOKE/CO2 DETECTORS IN EACH SPACE
 DATA PORTS THROUGHOUT (24 TOTAL)
 RECEPTACLES THROUGHOUT (24 TOTAL)
 LIGHT SWITCHES THROUGHOUT FOR INT. & EXT. FUNCTIONS
 HVAC THERMOSTAT
 COAT HOOKS (12)

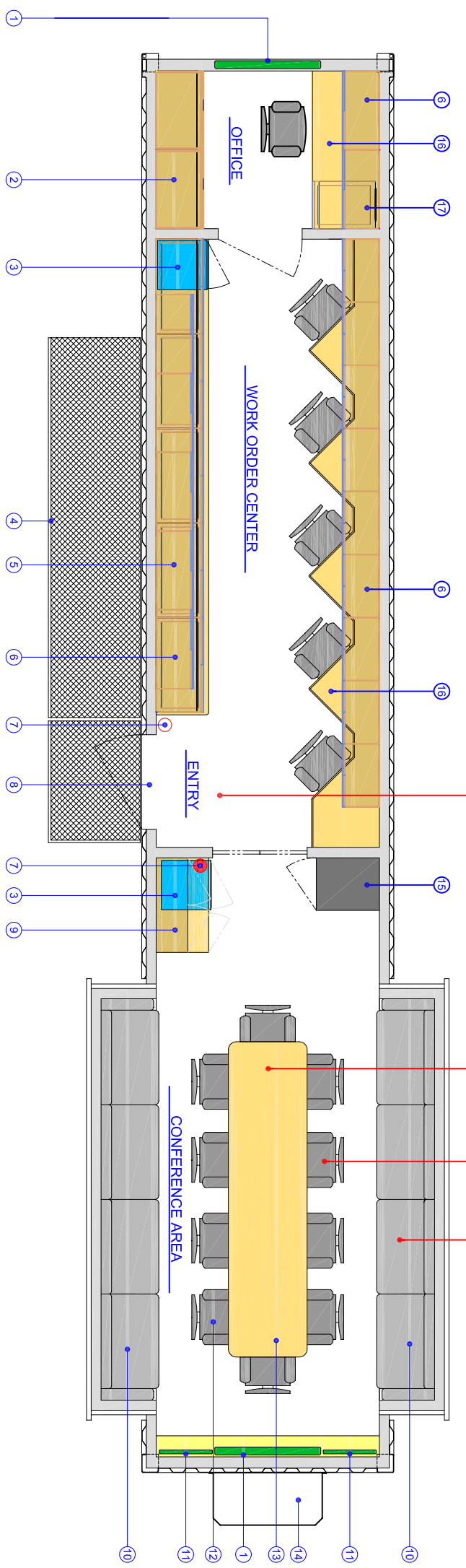

International Disaster Services
 703 Joe Tamplin Ind. Blvd.
 Macon, Georgia, U.S.A.
 Toll Free (866) 392-2674
 Local (478) 314-4750
 www.intl-disaster.com

CONFIDENTIAL
 The information hereon is confidential business information and may not be copied or used for any purpose unless permission is expressly granted in writing by:
INTERNATIONAL DISASTER SERVICES
 MACON, GEORGIA, USA

COMMAND CENTER II

| | | |
|-------|--------|--------|
| SIZE | CLIENT | REV |
| B | | |
| SCALE | TYPE | SHEET |
| NONE | LAYOUT | 1 OF 1 |